



Meaningful Innovation.

WEEE Number: 80133970

INSTRUCTION MANUAL

LED BULKHEAD

TECHNICAL DATA

MODEL	VT-80024
SKU	23596, 23597, 23598
POWER	24W
LUMENS	2500 LM
INPUT VOLTAGE	AC: 220-240V, 50/60Hz
BEAM ANGLE	Sphere 360°
CRI	≥80
DF	≥0.7
LIFE SPAN	25,000 Hours
ON/OFF CYCLE	10,000 Times
OPERATING TEMPERATURE	-20°C to +40°C
MATERIAL	PP+PP
DIMENSION	240x240x38mm



IP54
RATING

02
YEAR
WARRANTY*

*This product contains a light source of energy efficiency class<F>, where <F> shall be replaced by the energy class of the contained light source.

INTRODUCTION & WARRANTY

Thank you for selecting and buying V-TAC product. V-TAC will serve you the best. Please read these instructions carefully before starting the installation and keep this manual handy for future reference. If you have any another query, please contact our dealer or local vendor from whom you have purchased the product. They are trained and ready to serve you at the best. The warranty is valid for 2 years from the date of purchase. The warranty does not apply to damage caused by incorrect installation or abnormal wear and tear. The company gives no warranty against damage to any surface due to incorrect removal and installation of the product. The products are suitable for 10-12 Hours Daily operation. Usage of product for 24 Hours a day would void the warranty. This product is warranted for manufacturing defects only.

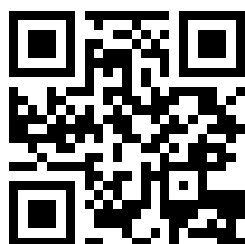

MULTI-LANGUAGE MANUAL QR CODE

Please scan the QR code
to access the manual in
multiple languages.



Points de collecte sur www.quefairedemesdechets.fr
Privilégiez la réparation ou le don de votre appareil !

In case of any query/issue with the product, please reach out to us at: support@v-tac.eu
For More products range, inquiry please contact our distributor or nearest dealers.
V-TAC EUROPE LTD. Bulgaria, Plovdiv 4000, bul.L.Karavelow 9B

WARNING

- Please make sure to turn off the power before starting the installation.
- Installation must be performed by a qualified electrician.
- If the external flexible cable or cord of this luminaire is damaged, it shall be exclusively replaced by the manufacturer or his service agent or a similar qualified person in order to avoid a hazard.
- Terminal block not included.
- The light source contained in this luminaire shall only be replaced by the manufacturer or his service agent or a similar qualified person.



This marking indicates that this product should not be disposed of with other household wastes.



Caution, Risk of electric shock

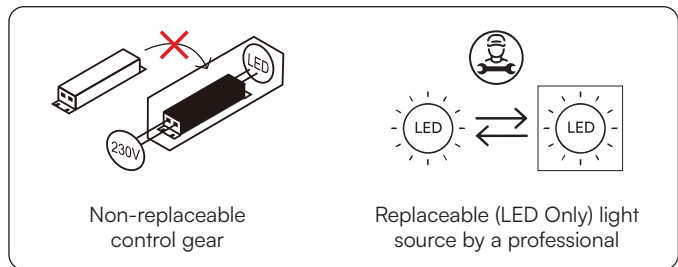

INSTALLATION INSTRUCTION

1

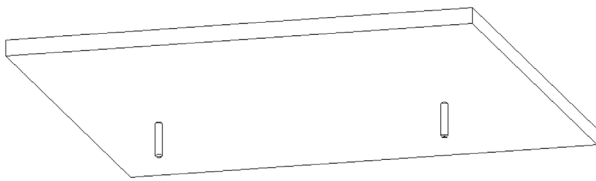

1. Drill holes on the wall, and plug the expansion sleeve into the holes

2

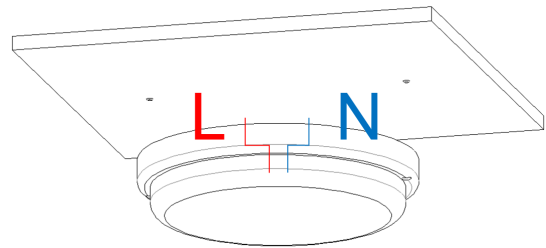

2. Connect the two input cables to L/N

3

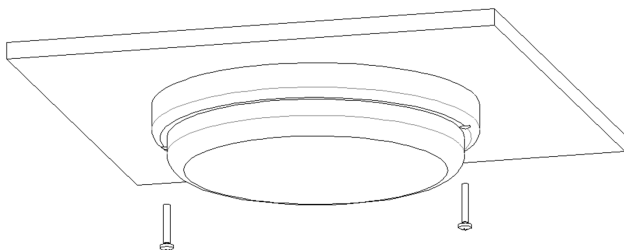

3. Align with the hole position and fix the lamp body with screws

4

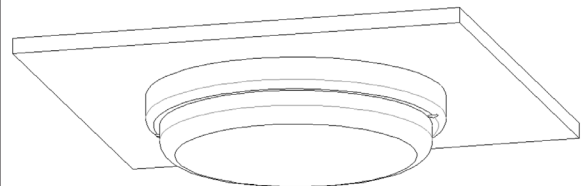

4. installed, turn on the light electricity, lamps and lanterns can normal use.

DISASSEMBLY INSTRUCTION

(FOR MARKET SURVEILLANCE TEAM ONLY)

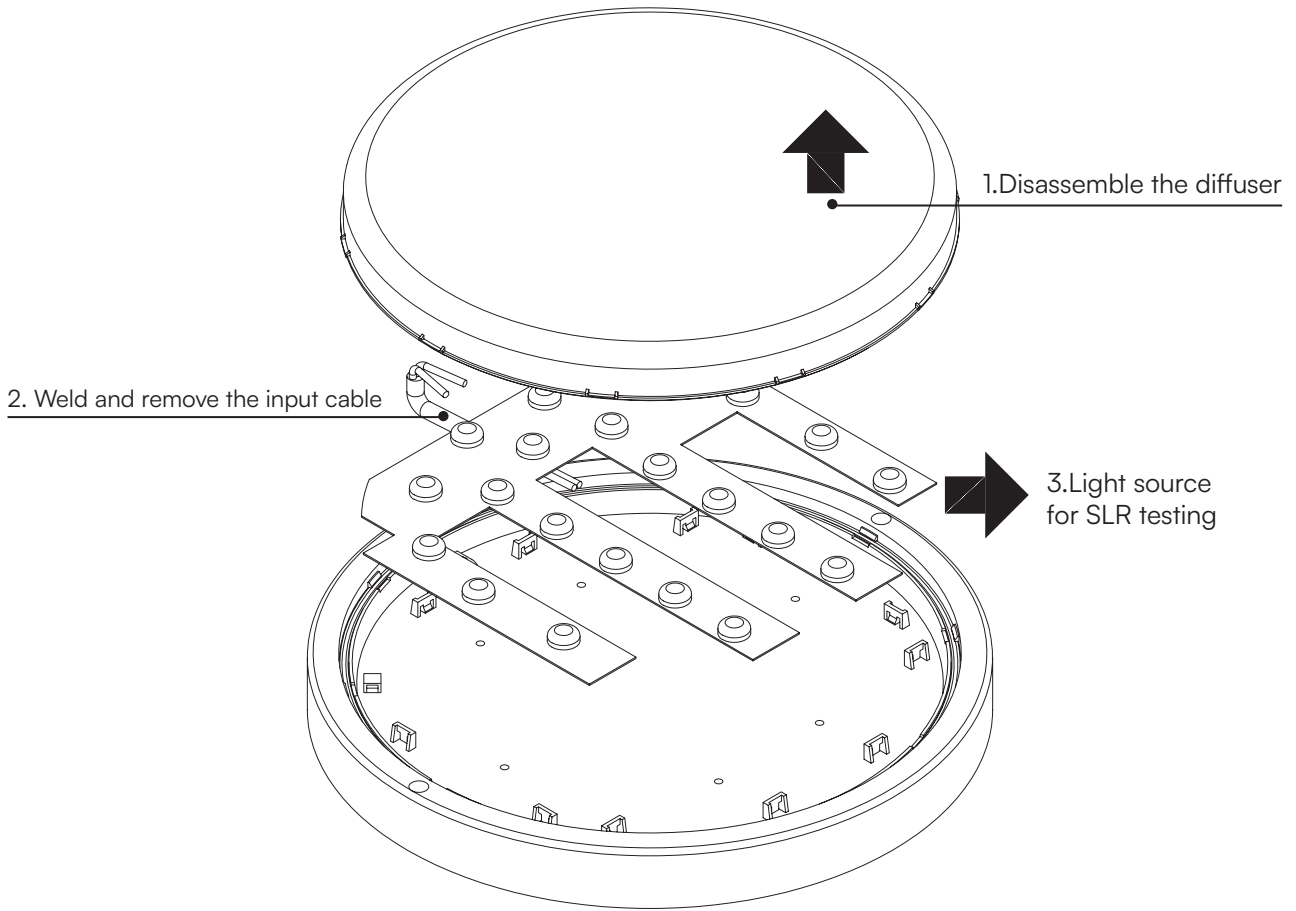

Note: Light source removal will void the warranty