



Meaningful Innovation.

WEEE Number: 80133970

INSTRUCTION MANUAL

LED FLOOD LIGHT

TECHNICAL DATA

MODEL	VT-44034	VT-44053
SKU	23462	23463
POWER	30W	50W
LUMENS @WIDE CONE	2310 Lm	4000 Lm
INPUT VOLTAGE	AC: 220-240V, 50Hz	
DF	>0.9	
CRI	70	
EFFICIENCY	90+ Lm/w	
LIFE SPAN	25,000 Hours	
ON/OFF CYCLE	15,000 Times	
BEAM ANGLE	115°	
OPERATION TEMPERATURE	-20°C to +40°C	
BODY TYPE	Aluminium	
MAX.MOUNTING HEIGHT	<5 M	
WIRE LENGTH	0.15 M	
REMOTE RANGE	≤8-10 M	



IP65
RATING

02
YEAR
WARRANTY*

NET WEIGHT	0.35Kg	0.48Kg
PROJECTED AREA (mm ²)	25168.5	31011.5
DIMENSION	164.5x34x153mm	183.5x34x169mm

*This product contains a light source of energy efficiency class<F>,where <F> shall be replaced by the energy class of the contained light source.

INTRODUCTION & WARRANTY

Thank you for selecting and buying V-TAC product. V-TAC will serve you the best. Please read these instructions carefully before starting the installation and keep this manual handy for future reference. If you have any another query, please contact our dealer or local vendor from whom you have purchased the product. They are trained and ready to serve you at the best. The warranty is valid for 2 years from the date of purchase. The warranty does not apply to damage caused by incorrect installation or abnormal wear and tear. The company gives no warranty against damage to any surface due to incorrect removal and installation of the product. The products are suitable for 10-12 Hours Daily operation. Usage of product for 24 Hours a day would void the warranty. This product is warranted for manufacturing defects only.

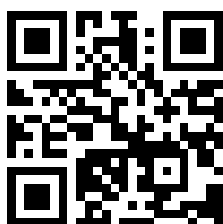

MULTI-LANGUAGE MANUAL QR CODE

Please scan the QR code to access the manual in multiple languages.



FR
Cet appareil, ses accessoires et cordons se recyclent

À DÉPOSER EN MAGASIN
OU
À DÉPOSER EN DÉCHÈTERIE

Points de collecte sur www.quefairedemesdechets.fr
Privilégiez la réparation ou le don de votre appareil !

In case of any query/issue with the product, please reach out to us at: support@v-tac.eu
For More products range, inquiry please contact our distributor or nearest dealers.
V-TAC EUROPE LTD. Bulgaria, Plovdiv 4000, bul.L.Karavelow 9B

WARNING

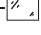
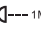
1. Please make sure to turn off the power before starting the installation.
2. Installation must be performed by a qualified electrician.
3. If the external flexible cable or cord of this luminaire is damaged, it shall be exclusively replaced by the manufacturer or his service agent or a similar qualified person in order to avoid a hazard.
4. Replace any cracked protective shield.  
5. Terminal block not included.
6. Proper grounding should be ensured throughout the installation.
7. Minimum distance from lighted objects 1m. 
8. Limitation of use indoors and outdoor.

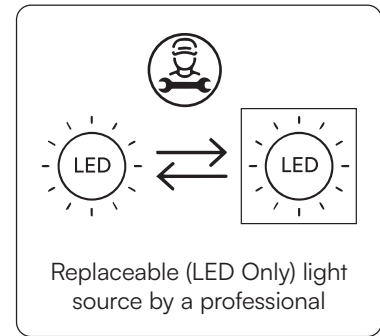

NOTE: To reduce the risk of strangulation the flexible wiring connected to this luminaire shall be effectively fixed to the wall if the wiring is within arm's reach.



This marking indicates that this product should not be disposed of with other household wastes.



Caution, risk of electric shock.

INSTALLATION DIAGRAM

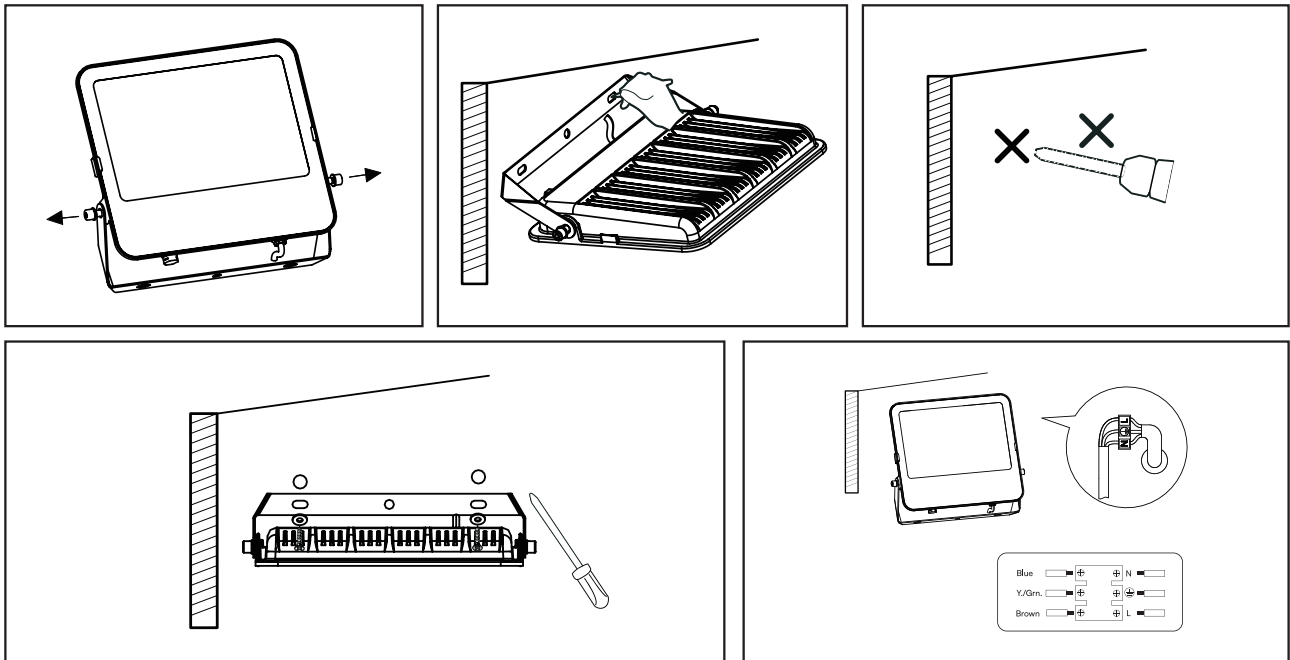

INSTALLATION INSTRUCTION

- DO NOT USE IN AREAS WITH LIMITED VENTILATION OR OUTSIDE THE RATED AMBIENT TEMPERATURE RANGE. *CONNECT WITH WATERPROOF CABLE HOUSE ONLY. *ENSURE ELECTRICITY IS SWITCH OFF BEFORE INSTALLATION.
- Please do not mount to a surface that is prone to vibrations.*
Remove the screw and the bracket afterward. (Figure 1) Before drilling, mark the hole position for fixing the bracket onto the wall (Screw not supplied). (Figure 2)
- Screw the retaining bracket to the wall with a suitable quantity of screws. (Figure 4)
- Mount the bracket back to the fixture. Adjust the floodlight according to the desired position. Tighten the screw. (Figure 5) Connect your main cable (HO5RN-F3G1.0mm² Recommended) with the input lead of our product through the waterproof junction box. Note, the line (-) of the lead. (Need to use the junction box of IP65 or above, ensure to tighten the waterproof screw) Switch on the power to make sure if the product is working.

DISASSEMBLY DIAGRAM

For Market surveillance team only

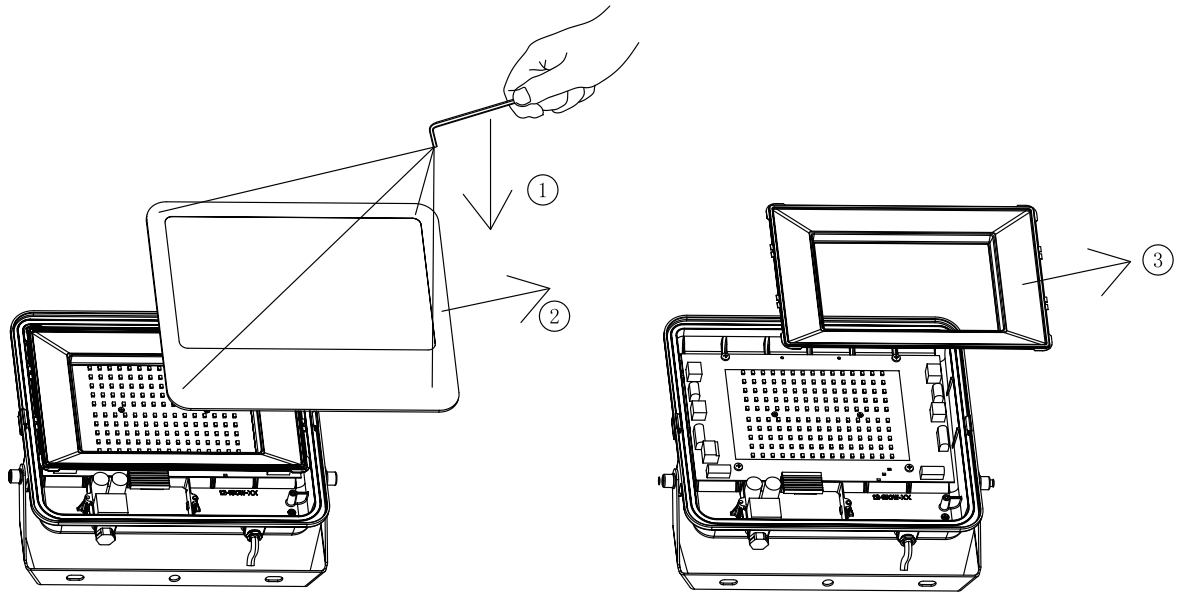

Note: Light source removal will void the warranty

REMOTE CONTROL FUNCTIONS



REMOTE CONTROL FUNCTIONS			
	On		Off
	Increase Brightness		Red
	Decrease Brightness		Blue
	6500K		Green
	Red, Green & Blue alternating rapidly flashing		Red, Green & Blue alternating slow flashing
	Red, Green & Blue Mixed alternating		Red, Green & Blue Breathing state
		Multiple Color Options	