

INSTRUCTION MANUAL INFRARED CONTROLLER

TECHNICAL DATA:

SKU	7805
OPERATION TEMPERATURE	-20°C to +60°C
INPUT VOLTAGE	DC5V -24V
OUTPUT	SPI Signal
STATIC POWER CONSUMPTION	<1W
CONTROLLER SIZE	66x34x12 mm
NET WEIGHT	50g
GROSS WEIGHT	60g
REMOTE	<20M, Frequency 2.4 g
REMOTE CONTROLLER SIZE	123x40x8mm



02 YEAR
WARRANTY

INTRODUCTION & WARRANTY

Thank you for selecting and buying V-TAC product. V-TAC will serve you the best. Please read these instructions carefully before starting the installation and keep this manual handy for future reference. If you have any another query, please contact our dealer or local vendor from whom you have purchased the product. They are trained and ready to serve you at the best. The warranty is valid for 2 years from the date of purchase. The warranty does not apply to damage caused by incorrect installation or abnormal wear and tear. The company gives no warranty against damage to any surface due to incorrect removal and installation of the product. The products are suitable for 10-12 Hours Daily operation. Usage of product for 24 Hours a day would void the warranty. This product is warranted for manufacturing defects only.

WARNING

1. Please make sure to turn off the power before starting the installation.
2. Installation must be performed by a certified person.



This marking indicates that this product should not be disposed of with other household wastes.



Caution, risk of electric shock.



MULTI-LANGUAGE MANUAL QR CODE

Please scan the QR code to access the manual in multiple languages.

WIRING DIAGRAM:

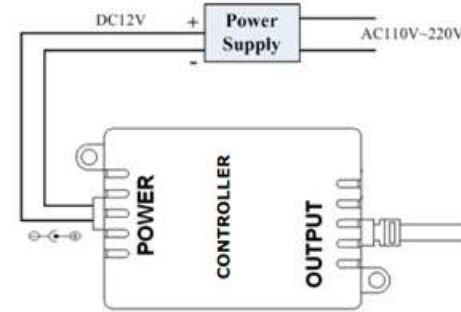

Cautions

1. This products Input voltage is DC5-24V,other input voltage are not allowed.
3. Overload are prohibited.

REMOTE CONTROL KEY FUNCTIONS:

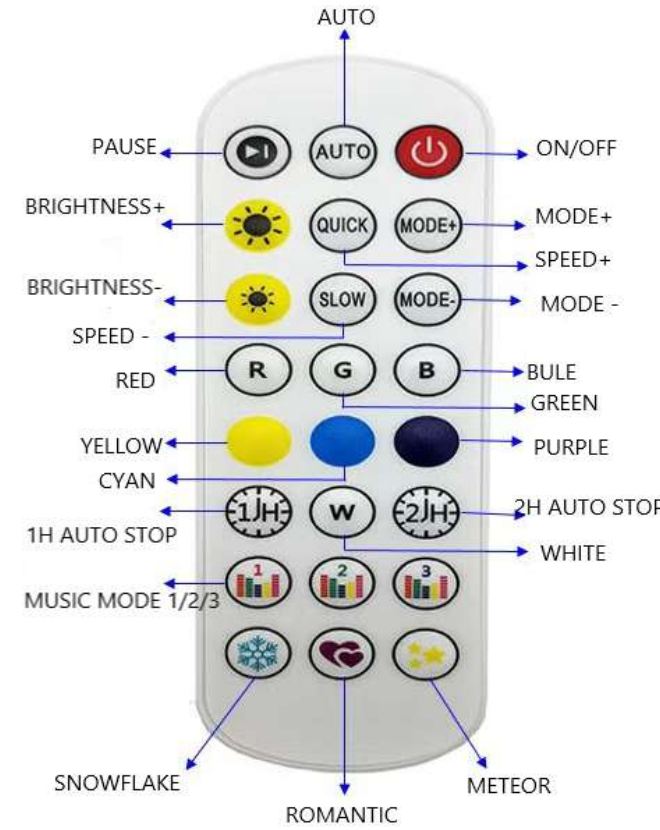

APP INSTALLATION

Scan the given QR code, or download "LotusLamp X" from the App Store (iOS) or the Google Play Store (Android).



APP USAGE INSTRUCTIONS

NOTE: Kindly enable Bluetooth on the device, before opening the app.

- (1) When opening the app, Bluetooth will automatically search and show list of available light. Kindly select 3-RGB Magic Strip/Light

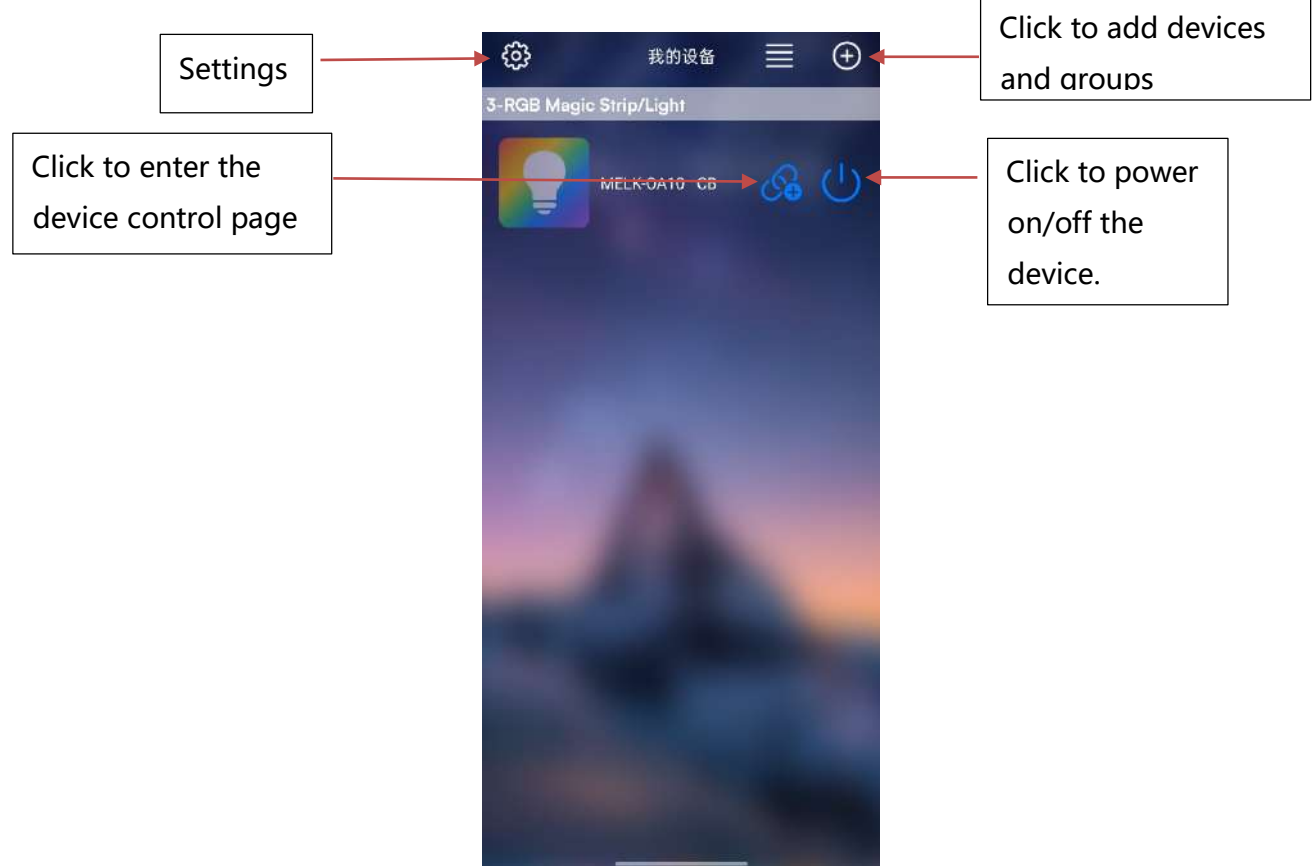

RHYTHM INTERFACE

Click to switch between music, mobile phone microphone and external microphone



Music List

Music rhythm through mobile microphone

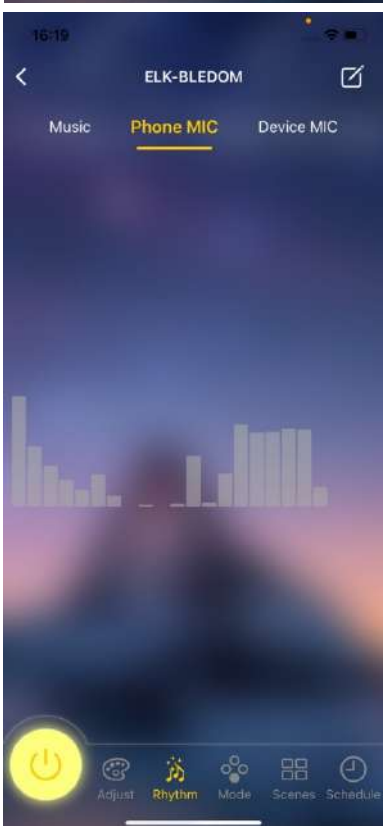

MODE INTERFACE

Scroll the selection mode

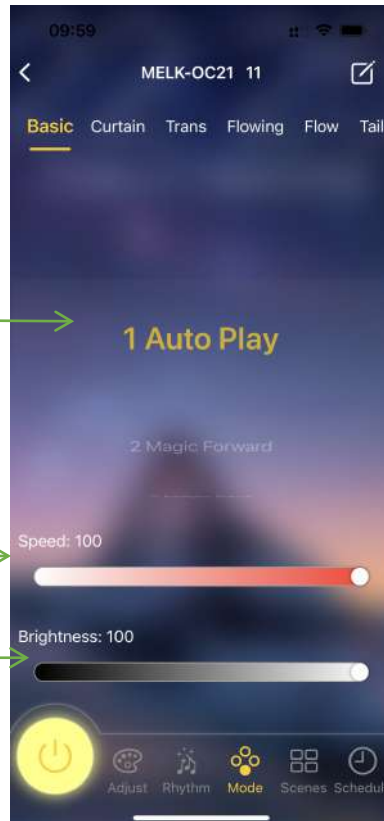

Adjust speed

Adjust luminance

SCENE INTERFACE

Click to switch the scene mode

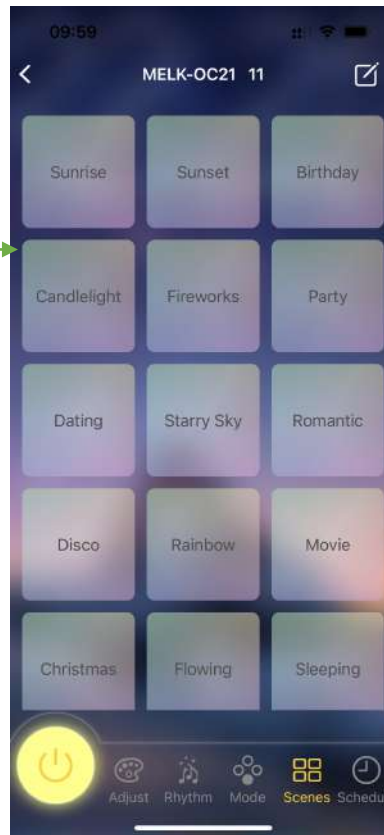

SCHEDULE INTERFACE

Set the time of Light-On

Set the time of Light-Off

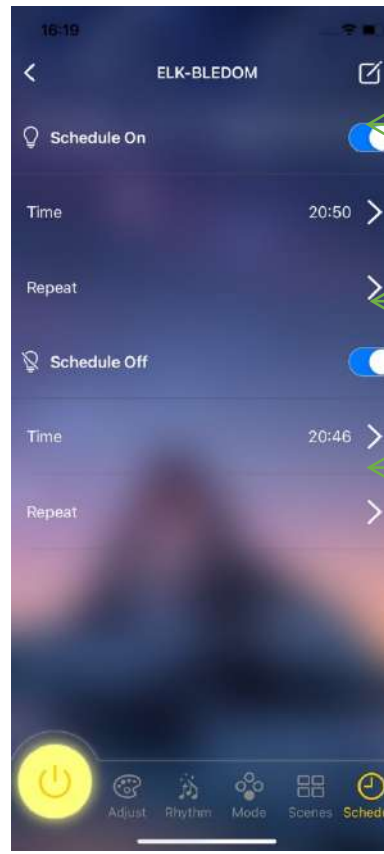

Enable or disable the Light-On function

Enable or disable the Light-Off function

Repeat setting No selection for once Light-On

SETTINGS

Detect devices and add them automatically

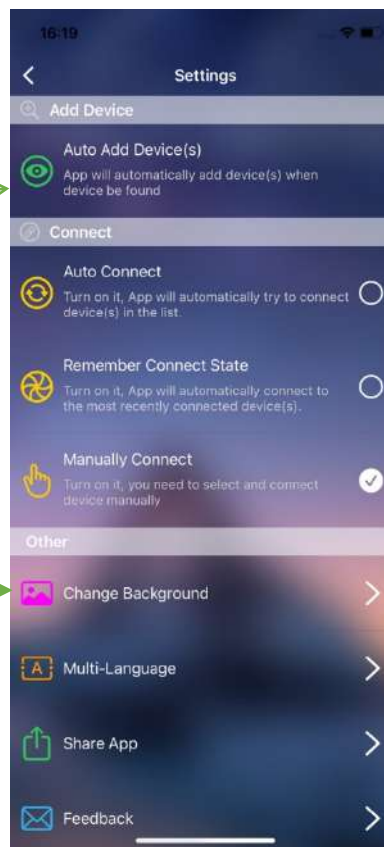

Set Connection Rules

Click to change the background image

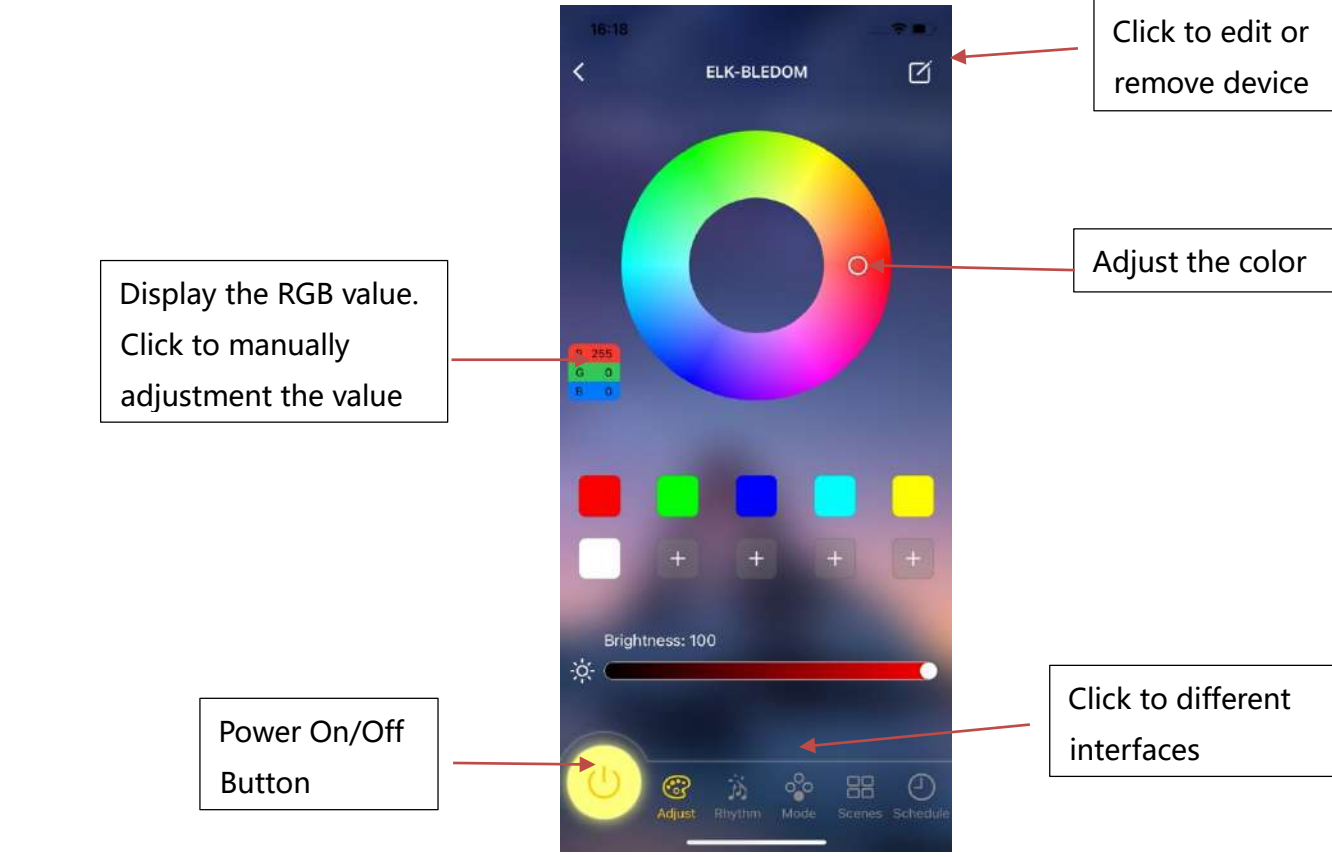

RGB VALUE MANUAL ADJUSTMENT

